



TIANSHUI HUATIAN SENSOR

CYB4200 SERIES PRESSURE TRANSMITTER

1 Product introduction

CYB4200 series pressure transmitter is a rod-shaped small-profile pressure transmitter. Select high-reliability silicon piezoresistive pressure sensor as the sensitive core, after temperature compensation, digital circuit correction and signal conditioning, output standard industrial applications and networking signals. Each type of product has undergone careful design, component screening, process verification and curing, cyclic loading to remove stress, aging, environmental simulation testing and other processes to ensure that each product is stable and reliable.



Tianshui Huatian Sensor Co., Ltd

天水华天传感器有限公司



CYB4211



2 Features

- ◆ compact size, easy to install
- ◆ full range coverage
- ◆ high stability, low drift
- ◆ a variety of structures to choose from
- ◆ can be applied to various industrial occasions, strong versatility

3 Main uses

The CYB4200 series pressure transmitter is widely used in various pressure measurement users with its excellent accuracy and reliability. Especially in the coal mine, oil field, chemical industry, civil explosion, environmental protection, medicine, water affairs, shipping and other industries, Huatian brand pressure transmitters have been widely recognized by customers.

4 Technical indicators

Range	MPa	-0.1MPa...0kPa~10kPa...100MPa		
Type of pressure		G、A、S		
Output signal (mA)		4~20		
		0~5V(0~10) three-wire system		
Accuracy level		0.1 (customized)	0.25	0.5
Nonlinearity (FS%)		≤0.1	≤0.2	≤0.4
Hysteresis、 Repeatability (FS%)		≤0.05	≤0.05	≤0.1
Zero point and sensitivity temperature drift (%FS/°C)		≤0.015	≤0.03	≤0.05
Long-term stability(%FS/year)		≤0.1	≤0.2	≤0.5
Working voltage (VDC)		+15~+30 (the calibration value is +24)		
Compensation temperature (°C)		0~+50 (≤200kPa) , -10°C~70°C (>200kPa)		
Working temperature (°C)		-40~+85		
Overload capacity (%)		≤200 (<10MPa) ; ≤150 (≥100MPa)		
Load resistance (Ω)		R= (U-12.5) /0.02-RD Among them: U is the power supply voltage, RD is the internal resistance of the cable		
Response time (10%~90%) ms		≤1		
Measuring medium		Fluids compatible with 304, 316L or ceramics		
Diaphragm material		316L、 Titanium alloy or ceramic optional		
Shell material		304、 316L		
Interface		304、 316L is optional		
Protection level		IP65 (IP68 customizable)		

5 Transmitter size

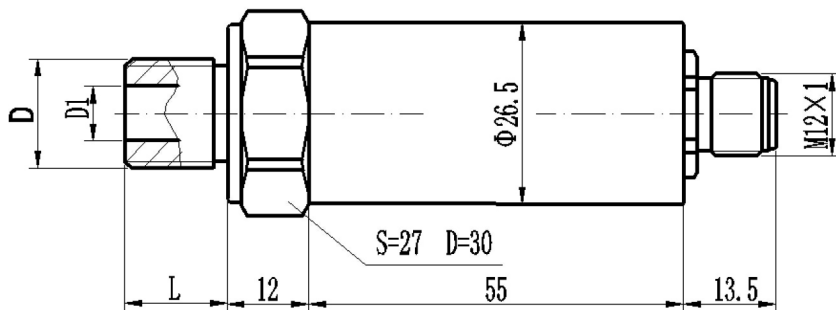

size D	length L	size D	length L	size D	length L	size D	length L
M22×1.5	15	M16×1.5	15	M8×1	12	3/8 PT	15
G 1/2	15	M14×1.5	15	G1/8	12	1/4 NPT	15
M20×1.5	15	G1/4	15	1/2NPT	18	1/4 PT	15
M18×1.5	15	M12×1	15	1/2PT	18	1/8 NPT	12
G3/8	15	M10×1	12	3/8 NPT	15	1/8 PT	12

Recommended optional connector size for CYB4200 series

6 Electrical connection

6.1 Horsman socket

Current type

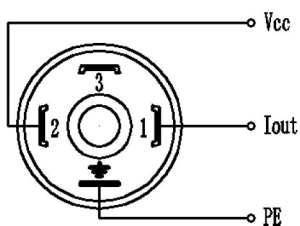

Voltage type

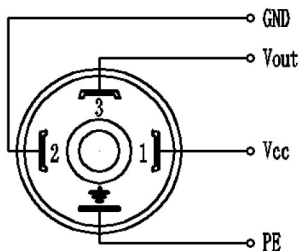

RS485 type

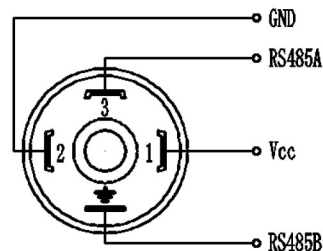

6.2 Aviation socket

Current type

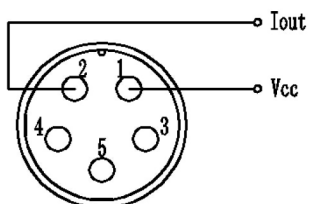

Voltage type

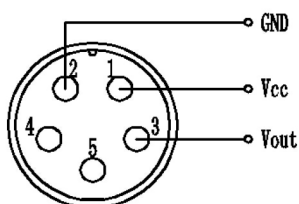

RS485 type

