



### 1. Features And Application

- ♦ The meter key can be adjusted and set freely
- ♦ Adjust without dead zone
- ♦ Full range optional
- ♦ High stability and reliability

### 2. Technical indicators

Range	-0.1MPa...0kPa~10kPa...100MPa		
Overload pressure	Below 10MPa ≤ 2 times full scale	10MPa and above ≤ 1.5 times full scale	
Pressure type	G (Gage) 、 A (Absolute) 、 S (Seal gauge)		
Accuracy level	0.1 (Customized)	0.25 (Typical)	0.5 (Maximum)
Long term stability	±0.1%FS/年 (Typical)		±0.2%FS/年 (Maximum)
Zero temperature drift	±0.03%FS/°C (≤100kPa)		±0.02%FS/°C (>100kPa)
Sensitivity temperature drift	±0.03%FS/°C (≤100kPa)		±0.02%FS/°C (>100kPa)
Compensation temperature	0°C~50°C (≤100kPa)		-10°C~70°C (>100kPa)
Medium temperature	-40°C~80°C		
Supply Voltage	15VDC~30VDC		
Output signal	Relay output	Relay output +4mA~20mA	High and low level output
Load resistance	Current type: ≤ (U-12) /0.02(Ω)		
Protection level	IP65		

### 3. Structural dimension drawing (typical)

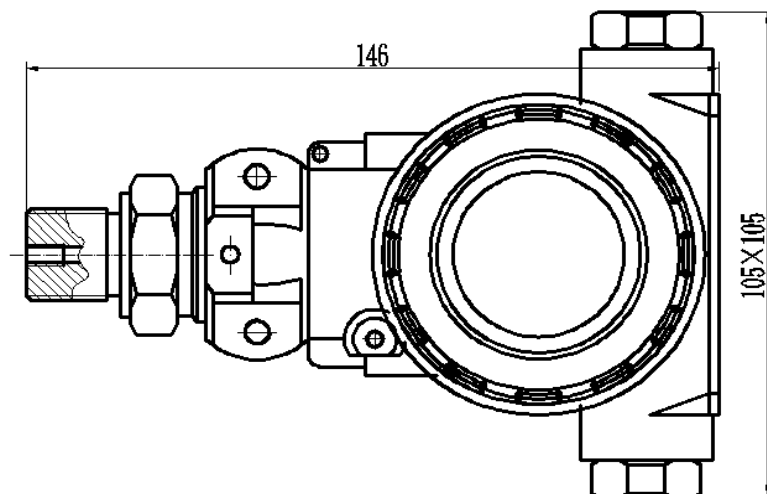

### 4. Order Guide

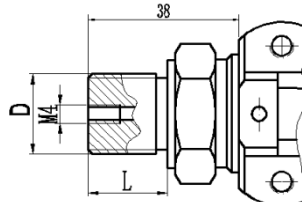
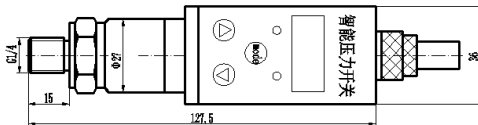
Model	Features	Outline drawing
CYBK0105	<ol style="list-style-type: none"> <li>1. Digital display and key setting;</li> <li>2. Pressure signal output;</li> <li>3. General appearance, standard mounting bracket.</li> </ol>	
CYBK0106	<ol style="list-style-type: none"> <li>1. High and low level output;</li> <li>2. Side display and key operation;</li> <li>3. Small size and intuitive display.</li> </ol>	

### 5. Precautions

5.1 Sealing measures shall be taken at the connection of pressure interface to prevent the leakage of pressurized liquid from causing pollution or accident.



# TIANSHUI HUATIAN SENSOR

## CYBK0100 SERIES PRESSURE SWITCH

5.2 Filter and buffer measures shall be taken at the pressure interface end to prevent sensor damage caused by particles or impact.

5.3 The temperature and humidity of the working environment shall meet the requirements of the product manual. If the operating environmental conditions are inconsistent with the product application conditions, please explain when ordering.